

KHANA HOUSE

In the first phase of organizing the overall plan, accesses, and restrictions were taken into consideration. The house was then made easier to access by utilizing homogenous materials and focused lighting. The next step involved the overall geometry of the house and adding obscured closets so that the areas that were virtually unutilized in the original design could once again be exploited. White stone on the floor and some walls are the primary building materials in the new design, which also provides an opportunity to centerpiece the color of the furniture and other interior accents. These materials are consumed to make the spot transpire grander and to give the house a more contemporary appearance.

To make the connection between the two floors as seamless as possible and to enlarge the living room on the ground floor, a linear staircase was used in the new design. Additionally, by utilizing the mirror in the stairway and living room walls, the living space is doubled and the visual connection between the public areas of the two floors is strengthened.



- 1. ENTRY
- 2. BEDROOM
- 3. LIVING ROOM
- 4. KITCHEN- SALON
- 5. TERRACE

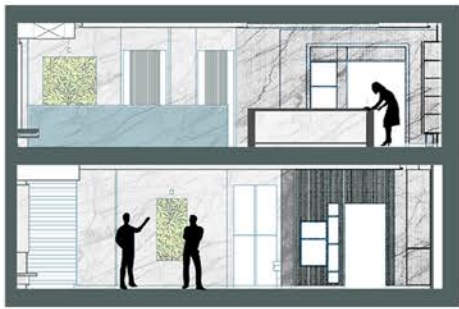

SECTION BB



SECTION AA

