

The U-shaped wood covering (along the window, ceiling and floor) is located in the middle of the space, and the other parts of the space are neutral and static, in complementary contrast, providing an opportunity to understand the movement of light as much as possible. The material of the woods is Russian, and we have also tried to maintain the brutal and natural state of the wood. The space created between the woods is used to illuminate the space, and its material is fabric and Barrisol. The lower boxes of the wood are installed as pots and vegetation; The vertical development of plant, can play a role in creating a sense of belonging of the inhabitants of the space to the office environment.

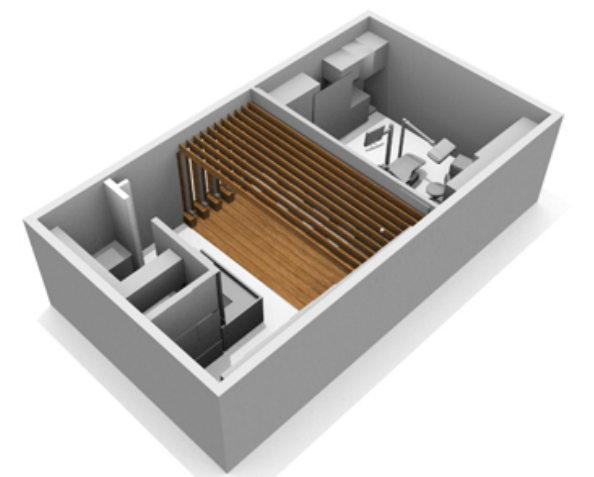

The second zone (medical services space) is fully functional and designed and planned based on the demands of the employer and paying attention to the size limit. It was also tried to show signs of duality in the waiting space in this space, but this time instead of Russian wood and plaster, prominent MDF wood design has been used.

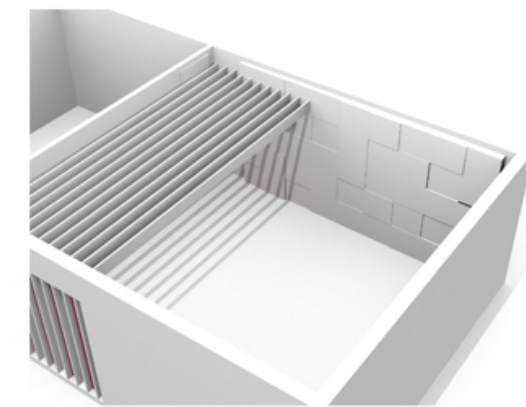
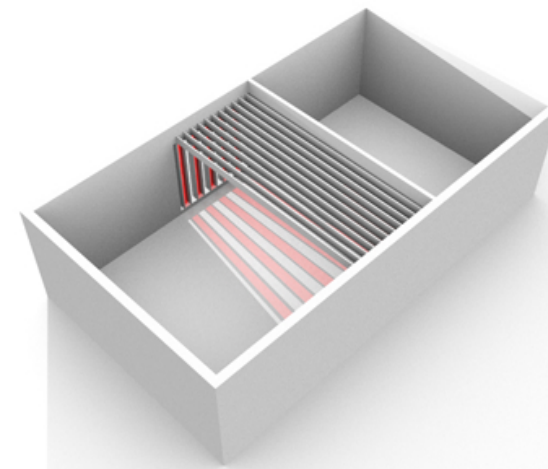