

Homeland Soldier's Memorial

A memorial reflecting presence of compatriots with the meaning of each individual a soldier

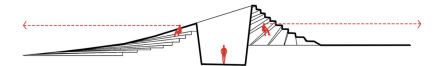

Introversion - Extroversion - Symbolism



Multiplicity of levels and visual angles - the possibility of performing artistic activities simultaneously

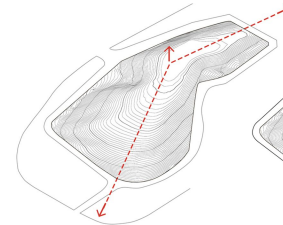

1- Selecting the highest topographic point
And the main axis of motion

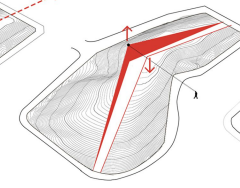

2- Turning point and peak - axes of view

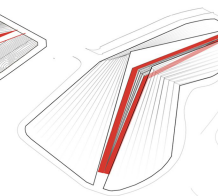

3- Internal circulation - direction and range of ramps

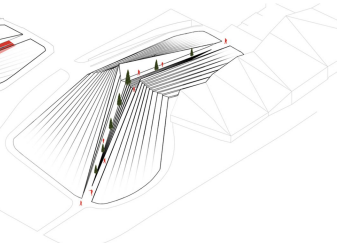

4-Symbolism - cypress trees - the presence of people

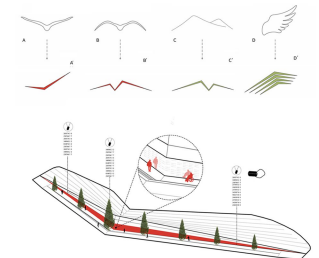
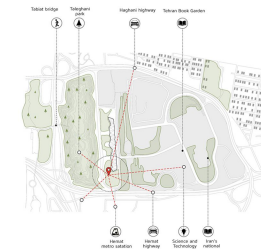
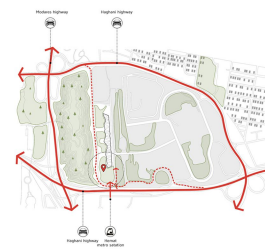

The formation of a memorial for the soldier of the country

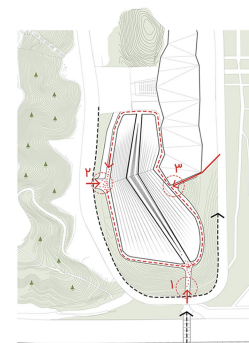

Circulation - access routes

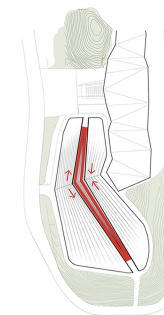

Direction, inner range, ramps

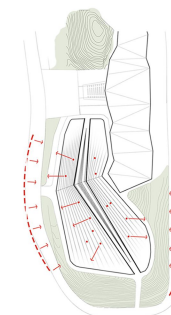

Gathering and open amphitheater - axes of view

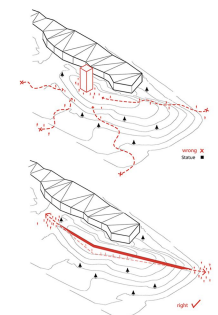

Navigation replaces "focus" - the presence of people replacing the statue