

# BARSIN COFFEE

Takeaway Café

Area: 51 m<sup>2</sup>  
Location: Tehran, Iran



Since Barsin Café is formed in a specific typology of commercial spaces, we called it "Commercial Boxes". These commercial boxes are usually located in the margins of the main streets. Three walls of the boxes with the roof and the floor are closed to the outside, and the box connects to the street with only one wall. In which this wall is either a vitrine or a glass defining a solid boundary from its interior to the exterior space. There is also a mezzanine located on a higher level, which acts as a warehouse or service space.

Our design strategy formed in a way to redefine the relationship between the commercial box and the city. With removing the border, it became necessary to increase the visual and physical relationship of the box and its neighborhood.

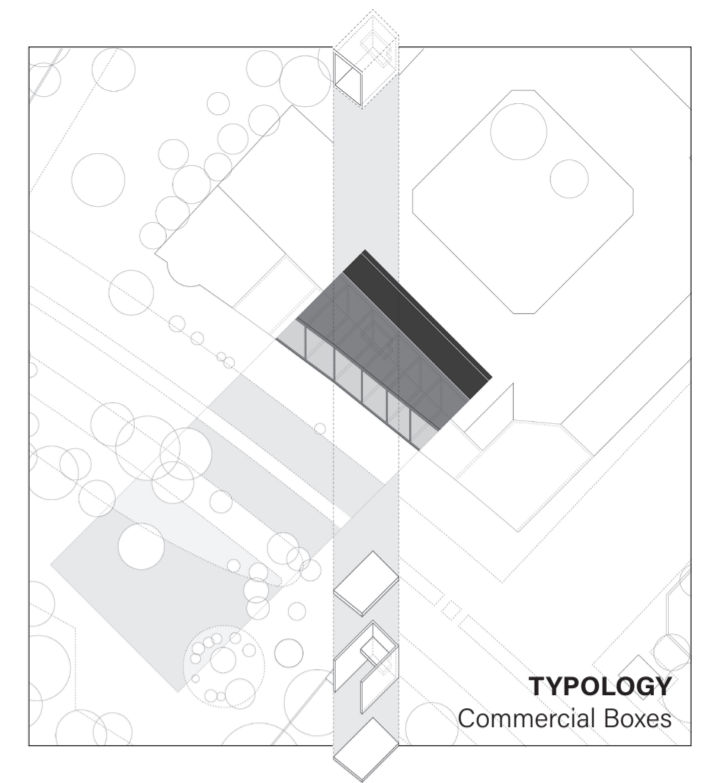

STRATEGY  
Digram

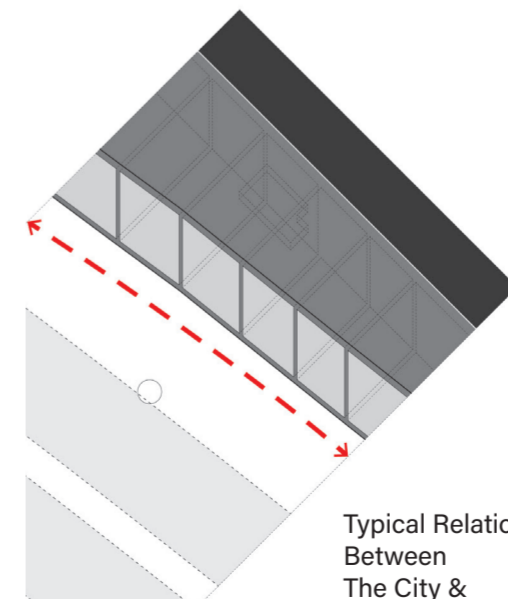
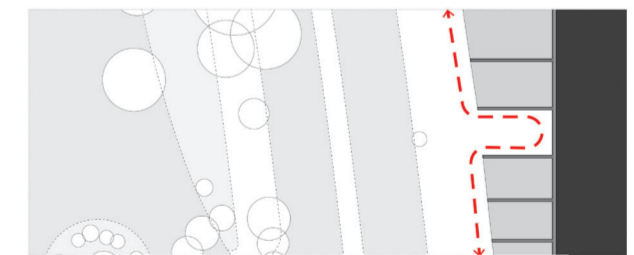
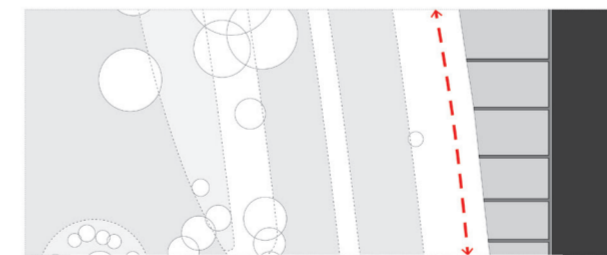

Typical Relationship  
Between  
The City &  
The Commercial Part

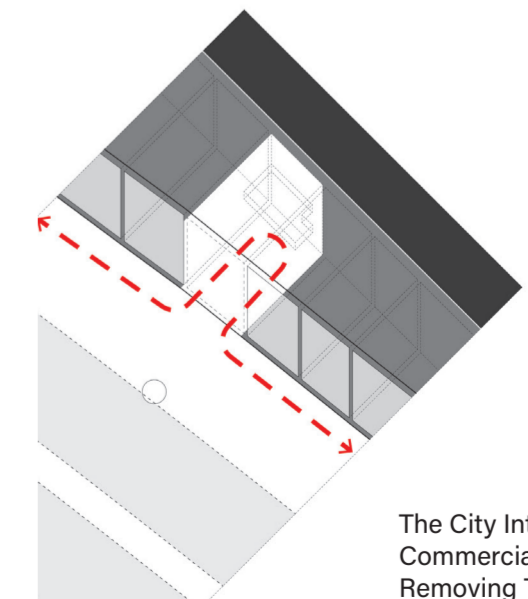

The City Into The  
Commercial Box By  
Removing The Border