

Oasis of Peace and Serenity

In the philosophy of Islam, a mosque must be rooted in both its time and location in order to be of value – therefore in this case an ambience of "Britishness" is a major factor in its creation and operation. So it provides a place of peace, one which draws in both worshippers, and other members of the community, in the form of a shared space for congregation, discussion, discourse and social activity.



Hilltop Garden with quranic fruits

Shan/ Courtyard

Female Praying Area

Cone of Light

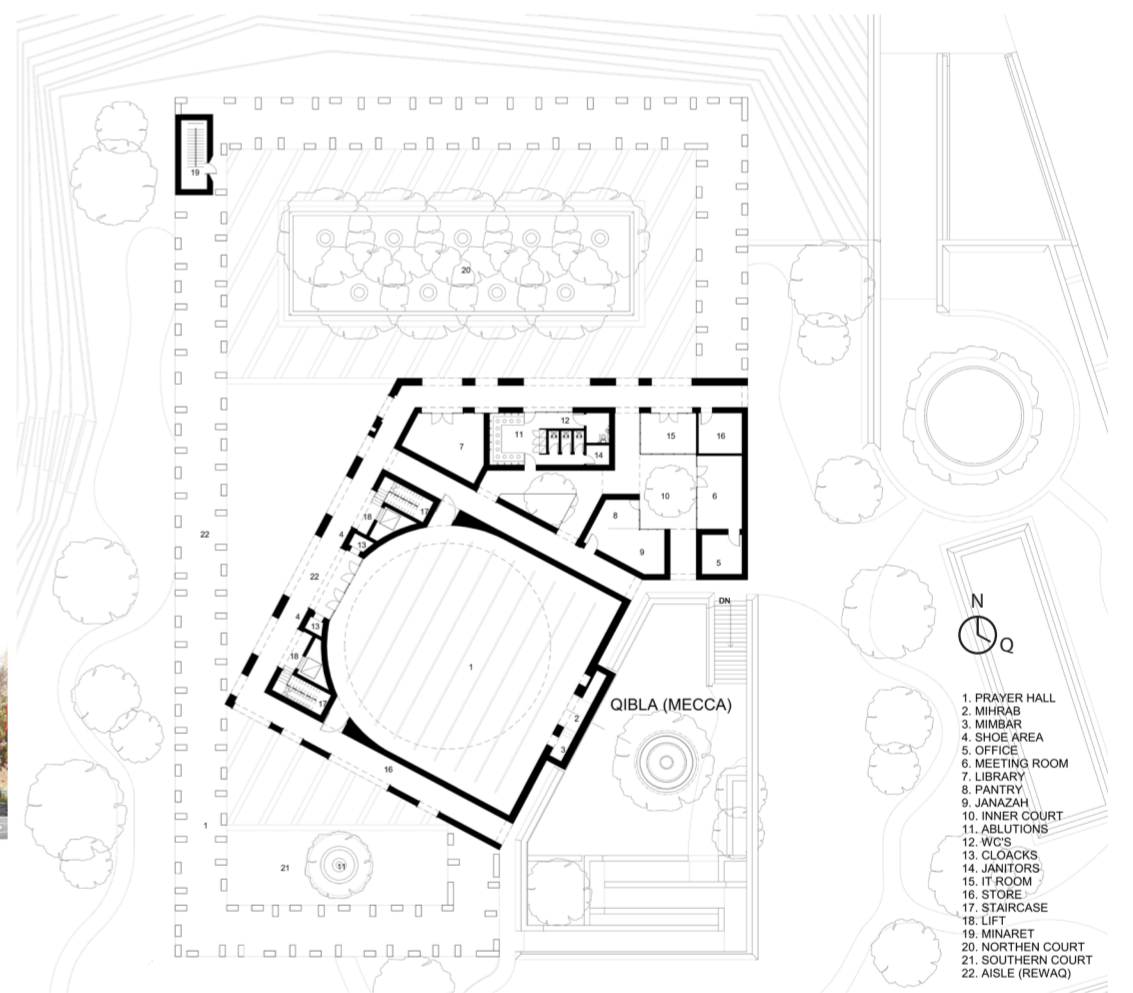
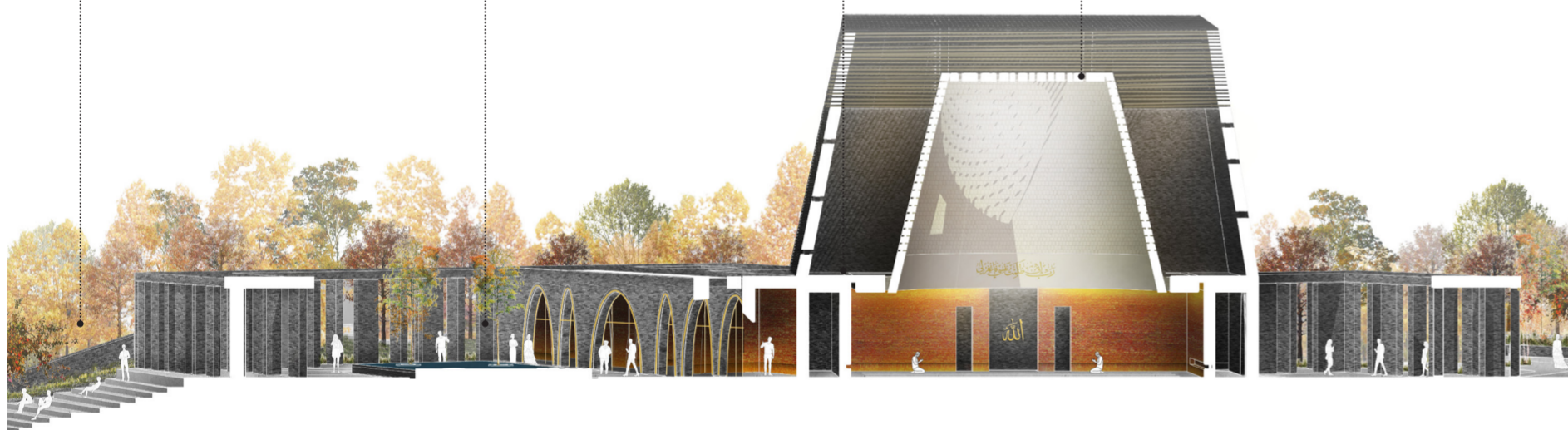

Cross Section

